

FLUSH CUT PULL SAW

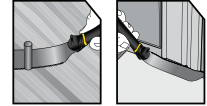

- Flexible blade for flush and finish cuts
- Quick-change blade to handle assembly
- Thin blade for cutting accuracy and clean finish
- Ergonomically designed cushion grip handle for comfort



| SKU # | Description | Blade Length (in.) | Blade Length (mm) | TPI | Box Qty |
|--------|--------------------|--------------------|-------------------|-----|---------|
| 20-500 | Flush Cut Pull Saw | 9" | 229 | 15 | 4 |

12" BASIC HACKSAW



- Robust, all-metal frame for durability
- Full grip handle helps protect knuckles
- Compact frame for comfort and control
- Large tensioning knob for ease of use
- 90° and 180° adjustable blade angles allowing flush cuts

| SKU # | Description | Blade Length (in.) | Blade Length (mm) | TPI | Box Qty |
|-----------|-------------------|--------------------|-------------------|-----|---------|
| STHT20138 | 12" Basic Hacksaw | 12" | 305 | 24 | 6 |

MINI-HACK™ UTILITY SAW



- 15809 - Durable solid aluminum construction
- 20807 – Durable solid plastic construction
- Ideal for hard-to-reach places
- Handle covers blade to help protect user's hands

| SKU # | Description | Blade Length (in.) | Blade Length (mm) | TPI | Box Qty |
|-------------|----------------------------------|--------------------|-------------------|-----|---------|
| STHT15809-8 | 10" Metal Mini-Hack™ Utility Saw | 10" | 250 | 24 | 6 |
| STHT20807-8 | 10" Mini-Hack™ Utility Saw | 10" | 250 | 24 | 6 |

COPING SAW



- Hardened, tempered provides clean, controlled cutting action
- 4 blades included
- Light weight wooden handle

| SKU # | Description | Blade Length (in.) | Blade Length (mm) | Frame Depth (mm) | TPI | Box Qty |
|-------------|---|--------------------|-------------------|------------------|-----|---------|
| STHT15104-8 | Coping Saw 120mm_4.75" Depth (4 blades) | 6-1/2" | 165 | 120 | 15 | - |
| STHT15106-8 | Coping Saw 170mm_6.75" Depth (4 blades) | 6-1/2" | 165 | 120 | 15 | - |