

## Steel Bench Vice | forged

- 360° rotary table with 3x10 mm mounting holes, lockable by sliding bar
- forged type
- screwed jaws

### BGS 59110

- max. clamping range: 120 mm
- length: 345 mm

### BGS 59112

- max. clamping range: 150 mm
- length: 385 mm

### BGS 59115

- max. clamping range: 200 mm
- length: 400 mm

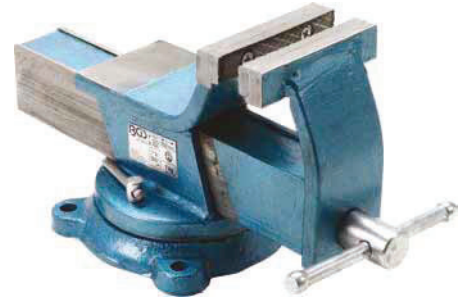

Item #	Description
59110	Steel Bench Vice   forged   100 mm Jaws
59112	Steel Bench Vice   forged   125 mm Jaws
59115	Steel Bench Vice   forged   150 mm Jaws

## Bench Vice

- 2 mounting holes Ø 8 mm
- screwed jaws

### BGS 59255 (length: 255 mm)

- Mounting hole distance: 83 mm
- max. clamping range: 75 mm

### BGS 59260 (length: 270 mm)

- Mounting hole distance: 80 mm
- max. clamping range: 110 mm

### BGS 59265 (length: 320 mm)

- Mounting hole distance: 95 mm
- max. clamping range: 130 mm

### BGS 59270 (length: 375 mm)

- Mounting hole distance: 107 mm
- max. clamping range: 170 mm

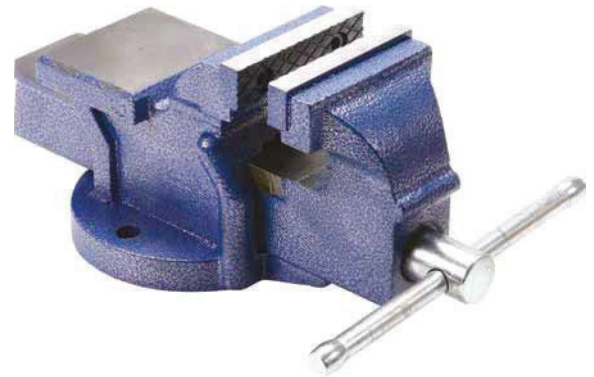

Item #	Description
59255	Bench Vice   75 mm Jaws
59260	Bench Vice   100 mm Jaws
59265	Bench Vice   125 mm Jaws
59270	Bench Vice   150 mm Jaws

## Locking Handle for Bench Vices

Item #	Description
59001	Locking Handle for Bench Vices   8 x 200 mm
59003	Locking Handle for Bench Vices   9 x 200 mm
59002	Locking Handle for Bench Vices   9 x 225 mm
59004	Locking Handle for Bench Vices   13 x 250 mm

