

Steel Bench Vice | forged

- 360° rotary table with 3x10 mm mounting holes, lockable by sliding bar
- forged type
- screwed jaws

BGS 59110

- max. clamping range: 120 mm
- length: 345 mm

BGS 59112

- max. clamping range: 150 mm
- length: 385 mm

BGS 59115

- max. clamping range: 200 mm
- length: 400 mm

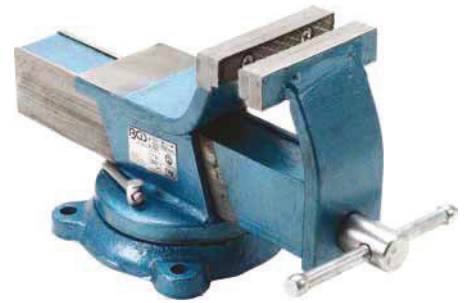

Item #	Description
59110	Steel Bench Vice forged 100 mm Jaws
59112	Steel Bench Vice forged 125 mm Jaws
59115	Steel Bench Vice forged 150 mm Jaws

Bench Vice

- 2 mounting holes Ø 8 mm
- screwed jaws

BGS 59255 (length: 255 mm)

- Mounting hole distance: 83 mm
- max. clamping range: 75 mm

BGS 59260 (length: 270 mm)

- Mounting hole distance: 80 mm
- max. clamping range: 110 mm

BGS 59265 (length: 320 mm)

- Mounting hole distance: 95 mm
- max. clamping range: 130 mm

BGS 59270 (length: 375 mm)

- Mounting hole distance: 107 mm
- max. clamping range: 170 mm

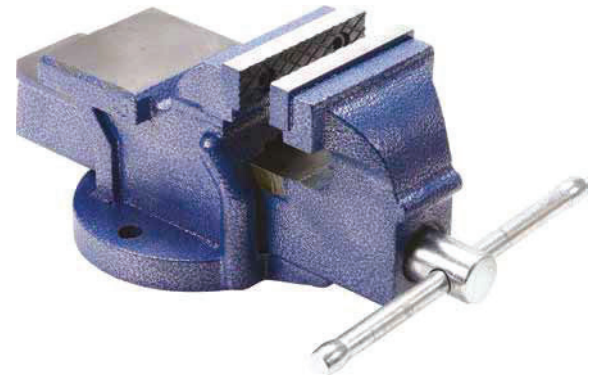

Item #	Description
59255	Bench Vice 75 mm Jaws
59260	Bench Vice 100 mm Jaws
59265	Bench Vice 125 mm Jaws
59270	Bench Vice 150 mm Jaws

Locking Handle for Bench Vices

Item #	Description
59001	Locking Handle for Bench Vices 8 x 200 mm
59003	Locking Handle for Bench Vices 9 x 200 mm
59002	Locking Handle for Bench Vices 9 x 225 mm
59004	Locking Handle for Bench Vices 13 x 250 mm

