

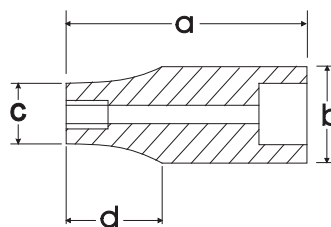

Metric Standard Chrome Sockets

Size	6 POINT Part No.	12 POINT Part No.	Overall Length (a) inches	Drive End (b) inches	Hex End (c) inches	Taper Length (d) inches	Net Weight (lbs)
6 mm	D008006	D009106	1.10	0.66	0.39	0.47	0.05
7 mm	D008007	D009107	1.10	0.66	0.43	0.47	0.05
8 mm	D008008	D009108	1.10	0.66	0.47	0.47	0.05
9 mm	D008009	D009109	1.10	0.66	0.52	0.47	0.05
10 mm	D008010	D009110	1.10	0.66	0.58	0.47	0.05
11 mm	D008011	D009111	1.10	0.66	0.62	0.47	0.06
12 mm	D008012	D009112	1.10	0.66	0.66	0.00	0.06
13 mm	D008013	D009113	1.10	0.70	0.70	0.00	0.06
14 mm	D008014	D009114	1.10	0.78	0.78	0.00	0.08
15 mm	D008015	D009115	1.10	0.86	0.86	0.00	0.10
16 mm	D008016	D009116	1.10	0.86	0.86	0.00	0.10
17 mm	D008017	D009117	1.18	0.94	0.94	0.00	0.10
18 mm	D008018	D009118	1.18	1.02	1.02	0.00	0.10
19 mm	D008019	D009119	1.18	1.02	1.02	0.00	0.12
20 mm	D008020	D009120	1.18	1.09	1.09	0.00	0.15
21 mm	D008021	D009121	1.18	1.09	1.09	0.00	0.15
22 mm	D008022	D009122	1.18	1.17	1.17	0.00	0.16
23 mm	D008023	D009123	1.18	1.25	1.25	0.00	0.16
24 mm	D008024		1.18	1.25	1.25	0.00	0.17

* Meets A.N.S.I. standards



Metric Deep Chrome Sockets

Size	6 POINT Part No.	12 POINT Part No.	Overall Length (a) inches	Drive End (b) inches	Hex End (c) inches	Taper Length (d) inches	Net Weight (lbs)
6 mm	D008206	D009706	2.48	0.66	0.39	1.50	0.09
7 mm	D008207	D009707	2.48	0.66	0.43	1.50	0.09
8 mm	D008208	D009708	2.48	0.66	0.47	1.50	0.09
9 mm	D008209	D009709	2.48	0.66	0.52	1.50	0.10
10 mm	D008210	D009710	2.48	0.66	0.58	1.50	0.10
11 mm	D008211	D009711	2.48	0.66	0.62	1.50	0.11
12 mm	D008212	D009712	2.48	0.70	0.70	0.00	0.11
13 mm	D008213	D009713	2.48	0.74	0.74	0.00	0.13
14 mm	D008214	D009714	2.48	0.78	0.78	0.00	0.16
15 mm	D008215	D009715	2.48	0.86	0.86	0.00	0.18
16 mm	D008216	D009716	2.48	0.86	0.86	0.00	0.20
17 mm	D008217	D009717	2.48	0.94	0.94	0.00	0.23
18 mm	D008218	D009718	2.48	1.02	1.02	0.00	0.25
19 mm	D008219	D009719	2.48	1.02	1.02	0.00	0.27
20 mm	D008220		2.48	1.09	1.09	0.00	0.33
21 mm	D008221		2.48	1.09	1.09	0.00	0.34
22 mm	D008222		2.48	1.17	1.17	0.00	0.37
23 mm	D008223		2.48	1.25	1.25	0.00	0.38

* Meets A.N.S.I. standards